

### WEIGHTS

Gross kerb weight	according to equipment
G.V.W. max permitted weight	20,000 kg

### DIMENSIONS

Overall length Std / BRT version (in option)	12,050 / 12,302 m
Overhang Std / BRT version (in option)	2,705 / 2,957 m
Wheelbase	6,120 m
Overall width	2,550 m
Total height, full load	3,295 m
Inside headroom (front part/rear part)	2,384 / 2,262 m
Slope of the floor (rear part only)	7.2 %
1st step height	
Front door	0,320 mm
Center & rear door	0,330/0,340 mm
Width of front / center / rear doors	1,200 m
Floor height	0,340 mm
Ground clearance, under skirt	0,300 mm
Front/rear tracking	2,090/1,872 mm
Inner Turning radius	9,095 m
Outer Turning radius	10,890 m
Angle of attack / escape	7,4°/7°

### Layout 12m

24 seats + wheelchair space + driver

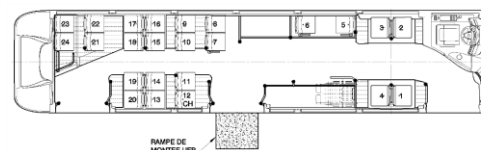

27 seats + wheelchair space + driver

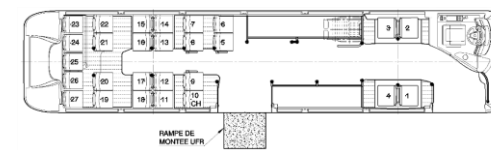



## E-WAY H2 – 12m

### TRACTION

Siemens ELFA 3 electric motor 290 kW peak power (R85)

Max torque 3000 Nm

1 NMC high energy density traction battery pack 69,3 kWh

Optimized SOC window to improve traction performance.

Charging system:

- 1 (or 2) hydrogen filling nozzle in front right side above front axle (or combined front right and left right as an option)

- 1 CCS Combo2 complying with ISO 15-118, located in the right back end of the vehicle

High Efficiency Fuel Cell HTWO system with fuel processing and thermal management able to charge the traction battery and contribute directly to supply energy to the electric motor (Mid-Power concept).

Roof mounted rack with hydrogen tanks in composite with aluminium liner.

The overall traction system delivers up to 400 km autonomy with no need to recharge or refill.

### CHASSIS AND STRUCTURE -EXTERIOR TRIM

Self-supporting integral structure. Anti-corrosion treatment of chassis by cathaphoretic immersion

Body structure consisting in 5 panels (front/rear/left/right/top) made of welded stainless-steel sections and sheet panels

Assembling of the 5 panels to the chassis by bolting. 12mm thick plywood floor, protected by phenolic resins on both sides and wax containing resins on ground side.

Composite front and rear ends, roof and side panels. Bonded assembly.

Gravel resistant protected wheel arches. Composite front and rear bumpers in 3 parts

With or without external advertising frames

BRT options:

- GX LINIUM front end

- Wheel covers

### ACCESS AND DOORS

2 or 3 inward swinging/sliding doors. Both leaves of front door are double glazed

Electric or Pneumatic doors

Manual or electrical 800mm access ramp on the central door

Manual or electrical left and right rear-view mirrors with self-defrosting and integrated flag holders

Camera mirrors with or without approach camera

### GLAZING -HEATING -COOLING

TSA tinted or Shade-Lite panoramic laminated glass windscreen bonded on front face

Driver's window: sliding type in front part

Bonded side windows. TSA tinted glass all round or Athermal Venus Grey 40 or 35 tinted except driver's window, front door and rear window

With or without triangular windows in platform area

Insulated roof

2 air extractors on rear part of the roof

Vehicle electric heating with 1 to 3 air heaters for passenger compartment

Thermal insulation for water circuit

With or without driver and passenger thermal comfort by CO2 Heat Pump

Thermal comfort pre-conditioning

### DRIVER'S COMPARTMENT

Adjustable steering wheel (height and angle)

Air-suspended driver's seat with adjustment control on right-hand side

VDV instrument panel with warning lamps and control display panel

Interior rear-view mirrors. Left side and front sun visor

Driver's individual with 2 spotlights, luggage box

Driver's door with or without anti-aggression gate

Wall behind the driver with a glazed upper part

ADAS/GSR equipment including :

- Blind spot info system
- Moving off info system
- Camera reverse
- Intelligent speed assistant (speed limit display)
- Driver drowsiness attention warning
- Alcohol interlock preparation
- Tires pressure monitoring
- Emergency stop signal

### INTERIOR TRIM

Wheelchair and pram space

Epoxy or stainless-steel handrails

High wear resistant floor covering up to plinths top

Laminated roof and side panels. Thermo-formed wheel arches. Polyester ceiling arches

With or without fire extinguisher

Cantilever seats

### ELECTRICAL EQUIPMENT

2-off 12 V 225 A/h maintenance-free batteries mounted on a sliding support located in an outside compartment at the vehicle front left-hand side.

Converter DC/DC 600/24 V + optional 24V plug in the rear compartment

Passenger compartment lighted by leds lights

Doorstep lighting at door opening

Lighting of driver's compartment, paying position and steps

External lights with leds: parking, stop, fog, reverse, turning, and marker lights

Thermal circuit-breakers.

Preparation for front, lateral and rear electronic destination panels

With or without flashing/stop indicators on the top of rear end

With or without complete radio equipment (tuner, USB, Bluetooth)

With or without mono-ring gong for pedestrian zone

With or without Front fog lights

With or without Preparation for ITxPT

Telematics system

Cybersecurity secure logger

# IVECO BUS

### FRONT AXLE

8,165 tons axle

Front independent wheels

### REAR AXLE

ZF AV 133

Axle torque: 7,36 (16x37)

### SUSPENSION

Constant height air suspension

Kneeling and raising system 72 mm stroke) on vehicle right hand side, controlled from the driving position

### COMPRESSED AIR

Pressure: 10 bars. Electric compressor (output: 400 l/min).

Single tower air dryer. Manual bleeding on the air tanks. Cyclonic air cleaner. Oil separator.

### BRAKES

Service brakes: air-controlled disc brakes at the front and at the rear

ABS-ASR braking system. EBS braking system

Parking brake and door brake controlled via separate circuits

Pneumatic parking brake actuated by lack of air, spring chamber on rear wheels

Service braking: electrical FAE

Brakes applied by opening of the central door

Retarder made by the electric traction motor

Manual retarder control

### WHEELS AND TYRES

Michelin or Bridgestone

275/70 R 22.5 tires at the front, twin tires at the rear.

With or without wheel covers.

### CERTIFICATION

In accordance with the R100-3 Regulation

In accordance with the appendix 8 of the ECE R107 Regulation and with the appendix 11 of the decree of August 3rd, 2007

Compliance with R66, R29 & R93 standards

Compliance with ISO 15-118 for smart charging