

CROSSWAY

CROSSWAY LE City 12 m & Line 12 / 13m – NATURAL GAZ EURO VI STEP E

IVECO
BUS
Drive the road of change



CROSSWAY LE NATURAL GAZ EURO VI STEP E		
LENGTH	12,050 mm	12,950 mm
WIDTH	2,550 mm	
HEIGHT	3,210 mm	
WHEELBASE	6,030 mm	6,945 mm
FRONT / REAR OVERHANG	2,725 / 3,295 mm	
FRONT / MIDDLE DOOR ACCESS HEIGHT	320 / 330 mm	
FRONT / MIDDLE DOOR WIDTH	800 (Line) - 1,200 (City) mm / 1,200 mm	
TURNING RADIUS (CURB TO CURB)	8,870 mm	10,070 mm
TURNING RADIUS (WALL TO WALL)	10,720 mm	11,930 mm
APPROACH / DEPARTURE ANGLES	7° / 7°	
MAX. TECHNICALLY PERMISSIBLE *		
GVW - LE LINE	17,900 kg	17,900 kg
GVW - LE CITY	19,500* kg	-
FRONT / REAR AXLE - LE LINE	6,300 / 11,600 kg	6,300 kg / 11,600 kg
FRONT / REAR AXLE - LE CITY	7,200 / 12,500 kg	-

* Max allowed vehicle axles load and GVW is depending on local regulation in registration country

CURSOR 9	
POWER @ 2500 RPM	265 kW (360 hp) @ 2,000 rpm
MAX TORQUE	1,600 Nm @ 1,200 rpm
DISPLACEMENT	8.7 litres
6 cylinders in line, vertical longitudinal at the rear, CNG	

LAYOUT (*)



Layout City 12m: 31 seats + 1 UFR

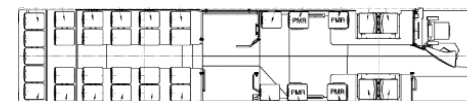

Layout City 12m: 35 seats + 1 UFR

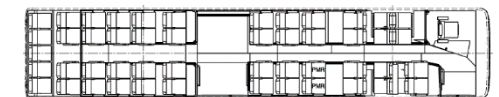

Layout Line 13m: 49 seats*

CROSSWAY

CROSSWAY LE City 12 m & Line 12 / 13m – NATURAL GAZ EURO VI STEP E

IVECO BUS

Drive the road of change

BODY AND EXTERIOR EQUIPMENT

- Anticorrosion cataphoretic treatment of the structure and of the body, finished with a polyurethane resin final coat.
- LE City: Front & middle doors 1,200 mm 2 leaves external opening
- LE Line: Front door 800 mm 1 leaf external opening ; middle door 1,200mm external opening.
- External rearview mirrors, heated, with electrical control

INTERIOR EQUIPEMENT

- Self-adhesive anti-slip PVC carpet on the floor
- Lateral walls covered by laminated panels
- Roof covered by laminated panels
- Separation walls made of laminated panels
- Central platform in front of the middle door
- Manual ramp for disabled persons
- LE City: Seat cantilever 8MI
- LE Line: Seats Lineo Fix

ELECTRICAL EQUIPMENT

- Two batteries 12 V – 225 AH
- Three alternators 150 A
- Electrical box with fuses
- Internal and external LED lights
- Fog lights with cornering function
- Fire extinguishing system
- Speed limiter 85 km/h (City) 100 km/h (Line)
- 24 V and 2x USB sockets on the dashboard

WINDOWS/ THERMAL COMFORT

- Tinted simple glass with 5 opening units
- Four heaters for the passenger compartment
- Anti-freeze step

DRIVER'S COMPARTMENT

- Adjustable driver's seat with air suspension, headrest, 3 pts safety belt
- Front sun visor with electrical control
- Driver's separation
- Driver's box with lock
- On board computer with fuel consumption control

ADAS/GSR equipment including :

- Blind spot info system (right side)
- Moving off info system
- Reverse camera
- Intelligence speed assist (speed limit display)
- Driver drowsiness attention warning
- Alcohol ignition interlock device preparation

OPTIONAL

- Other combination of front & middle doors (width, type of opening)
- Rear door 800 mm for LE City
- Ski carrier preparation
- Towing device preparation
- Towing device
- Rear, left or right advertisement panel

OPTIONAL

- Electrical ramp for disabled persons
- LE City: Seat cantilever Lineo City
- LE Line: seats Scoleo / Lineo Tilting / Cantilever Lineo Fix
- Step bus

OPTIONAL

- Warning lights with open doors
- Reverse sensors
- FMS plug
- Electrical box with circuit breakers
- 12 V socket on the dashboard

OPTIONAL

- Double glasses of the lateral windows, driver's window and passenger doors
- A/C with or without heating
- Electrical defrosting of the windshield
- Reinforced insulations of front and rear panel, side panels and roof

OPTIONAL

- Driver's seat with heating system
- Driver's refrigerator
- Driver's A/C
- Digital tachograph

OPTIONAL

- Blind spot info system (Left and Right)
- Alcohol ignition interlock device

GEARBOX

- Automatic ZF Ecolife

REAR AXLE

- Single reduction hypoid rear axle equipped with "Quiet ride gears set" for low noise
- Standard axle ratio: 5,63 (8x45)

FRONT AXLE / STEERING

- Front axle with independent wheels suspension
- Worm-type steering with integrated power steering

SUSPENSION

- Full air suspension with self-levelling sensor and kneeling
- Front: 2 combined air springs / 2 shock absorbers / 1 levelling sensor
- Rear: 4 air springs / 4 shock absorbers / 1 stabilization bar / 2 levelling sensors

COMPRESSED AIR

- Dual cylinder air compressor 630 cm³ (pressure 11 bar)
- Integrated air dryer: bleeding valves on the air tanks

BRAKES

- EBS (City), EBS/ESP (Line)
- Pneumatic service and emergency braking system with two independent air circuits
- Brake discs, front and rear, with floating callipers and ABS
- Pneumatic parking brake, operating on the rear wheels

RETARDER

- Decompression engine brake
- Hydraulic integrated retarder

CNG TANK

- 1280 L (4x320 L) Class III
- CNG filling: NGV 1 & NGV 2 on right hand side

TYRES AND WHEELS

- 275/70 R 22.5 tyres

OPTIONAL

- Automatic VOITH Diwa NXT

OPTIONAL

- Please see with our commercial representative

OPTIONAL

- Lifting of the vehicle's suspensions
- Reinforced shock absorbers

OPTIONAL

- ESP (LE City)

OPTIONAL

- 1260 L (4x315) Class IV
- NGV2 behind front bumper

OPTIONAL

- With spare wheel