

# CROSSWAY

CROSSWAY LOW ENTRY 12 m (CI, CII) & 13 m (CII) – NATURAL GAZ EURO VI STEP E

# IVECO BUS

Drive the road of change



CROSSWAY LE DIESEL EURO VI STEP E		
LENGTH	12,050 mm	12,950 mm
WIDTH	2,550 mm	
HEIGHT	3,210 mm	
WHEELBASE	6,030 mm	6,945 mm
FRONT / REAR OVERHANG	2,725 / 3,295 mm	
FRONT / REAR TRACK		
INTERIOR HEIGHT (MM) (AISLE)		
FRONT / MIDDLE / REAR DOOR ACCESS HEIGHT	320 / 330 mm	
FRONT / MIDDLE / REAR DOOR WIDTH	1,200 mm	
TURNING RADIUS (CURB TO CURB)	8,870 mm	10,070 mm
INTERNAL TURNING RADIUS		
TURNING RADIUS (WALL TO WALL)	10,720 mm	11,930 mm
APPROACH / DEPARTURE ANGLES	7° / 7°	
MAX. TECHNICALLY PERMISSIBLE GVW LINE*	17,900 kg	17,900 kg
MAX. TECHNICALLY PERMISSIBLE GVW CITY*	19,500* kg	
MAX. TECHNICALLY PERMISSIBLE AXLE LOADS*	FRONT / MIDDLE / REAR AXLE 6,300 / 11,600 kg	FRONT / MIDDLE / REAR AXLE 6,300 kg / 11,600 kg
	FRONT / MIDDLE / REAR AXLE 7,200 / 12,500 kg	

\* Max allowed vehicle axles load and GVW is depending on local regulation in registration country

CURSOR 9	
POWER @ 2500 RPM	265 kW (360 hp) @ 2,000 rpm
MAX TORQUE	1,600 Nm @ 1,200 rpm
DISPLACEMENT	8.7 litres
6 cylinders in line, vertical longitudinal at the rear, CNG	

## LAYOUT

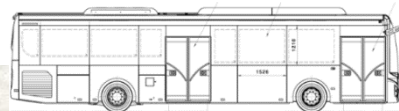

31 seats + 1 UFR

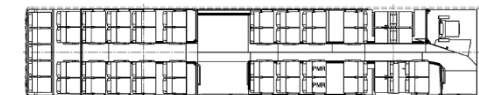

Layout 13 m: 49 passengers seats\*

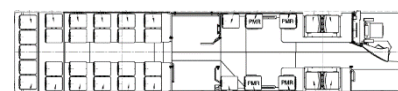

35 seats + 1 UFR

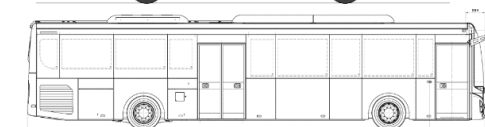

Layout 12 m: 45 passengers seats\*

\*Seat Layout can be changed in case of request

### BODY AND EXTERIOR EQUIPMENT

- Anticorrosion cataphoretic treatment of the structure and of the body, finished with a polyurethane resin final coat.
- Front door 1,200 mm 2 leaves, middle door 1,200 mm 2 leaves, external opening
- Access to the front lights bulbs through revolving headlamps

### INTERIOR EQUIPMENT

- Self-adhesive anti-slip PVC carpet on the floor
- Lateral walls covered by laminated panels
- Roof covered by laminated panels
- Separation walls made of laminated panels
- Central platform in front of the middle door
- Manual ramp for disabled persons
- person

### ELECTRICAL EQUIPMENT

- Two batteries 12 V – 225 AH
- Three alternators 150 A
- Electrical box with fuses
- Internal and external LED lights
- Corner light (integrated in the fog light)
- Fire extinguishing system
- Speed limiter 85 km/h (City) 100 km/h (Line)
- 24 V and 2x USB sockets on the dashboard

### WINDOWS/ THERMAL COMFORT

- Tinted simple glass with 5 opening units
- Four heaters for the passengers compartment

### DRIVER'S COMPARTMENT

- Adjustable driver's seat with air suspension, headrest, 3 pts safety belt
- Lateral and front sun visors with manual control
- Driver's separation
- On board computer with fuel consumption control

### ADAS/GSR equipment including :

- Blind spot info system (optional for fareside)
- Moving off info system
- Reverse camera
- Intelligence speed assist (speed limit display)
- Driver drowsiness attention warning
- Alcohol ignition interlock device preparation

### OPTIONAL

- Other door combinations for 2&3 door version
- External rearview mirrors, heated, with electrical control
- Ski carrier preparation
- Towing device preparation
- Towing device
- Rear, left or right advertisement panel

### OPTIONAL

- Electrical ramp for disabled persons
- Cantilever seats

### OPTIONAL

- Warning lights with open doors
- Reverse sensors
- FMS plug
- Electrical box with circuit breakers
- 12 V socket on the dashboard

### OPTIONAL

- Double glasses of the lateral windows, driver's window and passengers doors
- A/C with or without heating
- Electrical defrosting of the windshield
- Reinforced insulations of front and rear panel, side panels and roof

### OPTIONAL

- Driver's seat with heating system
- Driver's box with lock
- Driver's refrigerator
- Driver's A/C
- Front sun visor with electrical control
- Digital tachograph

### OPTIONAL

- Blind spot info system (Left and Right)
- High beam assist
- Alcohol ignition interlock device

### GEARBOX

- Automatic ZF Ecolife

### REAR AXLE

- Single reduction hypoid rear axle equipped with "Quiet ride gears set" for low noise
- Standard axle ratio: 5,63

### FRONT AXLE / STEERING

- Front axle with independent wheels suspension
- Worm-type steering with integrated power steering

### SUSPENSION

- Full air suspension with self-levelling sensor and kneeling
- Front: 2 combined air springs / 2 shock absorbers / 1 levelling sensor
- Rear: 4 air springs / 4 shock absorbers / 1 stabilization bar / 2 levelling sensors

### COMPRESSED AIR

- Dual cylinder air compressor 630 cm<sup>3</sup> (pressure 11 bar)
- Integrated air dryer: bleeding valves on the air tanks

### BRAKES

- EBS (City), EBS/ESP (Line)
- Pneumatic service and emergency braking system with two independent air circuits
- Brake discs, front and rear, with floating callipers and ABS
- Pneumatic parking brake, operating on the rear wheels

### RETARDER

- Decompression engine brake
- Hydraulic integrated retarder

### CNG TANK

- 1280 liters Class III
- CNG filling: NGV 1 & NGV 2 on right hand side

### TYRES AND WHEELS

- 275/70 R 22.5 tyres
- Spare wheel carrier in the front overhang

### OPTIONAL

- Automatic VOITH Diwa NXT

### OPTIONAL

- Please see with our commercial representative

### OPTIONAL

- Lifting/Lowering of the vehicle's suspensions
- Reinforced shock absorbers

### OPTIONAL

- ESP (City)

### OPTIONAL

- 310 litres diesel tank, 310+120 litres tank

### OPTIONAL

- 1260 liters Class IV
- NGV2 behind front bumper

### OPTIONAL

- With spare wheel